

Grundfos pump DEMS GRF706 C

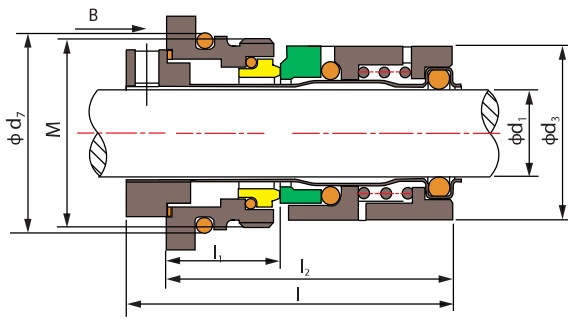

TS CR-12,14,16 Punched TYPE

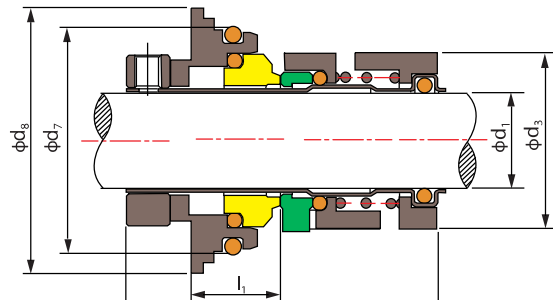

TS CR-22, Punched TYPE

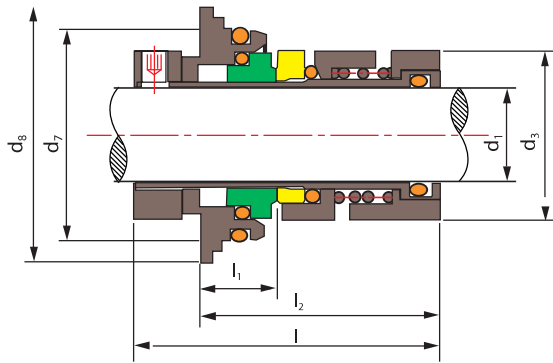

TS CR-22,32 Machined TYPE

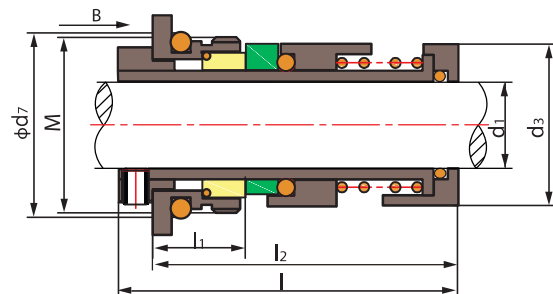

TS CR-12,14,16 Machined TYPE

- Rotary Ring (SiC/TC)
- Stationary Ring (SiC/TC)
- Secondary Seal(NBR/MITON)
- Spring & Other Parts(SUS304/SUS316)

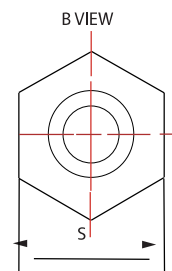

Model Modelo	d ₁	d ₃	d ₇	d ₈	M	l	l ₁	l ₂	S
CR-12	12	25.0	29	\	M28X1.5	55.0	19	49.0	35.8
CR-14	14	27.5	39	\	M33X1.5	56.0	18	49.0	40.8
CR-16	16	30.5	34	\	M33X1.5	57.5	20	50.5	40.8
CR-22	22	39.5	50	59	\	71.0	20	57.0	\
CR-32	32	53.0	61	71	\	70.0	20	55.0	\